

# 2011 Series

## Pin Header 2.54mm(0.100")

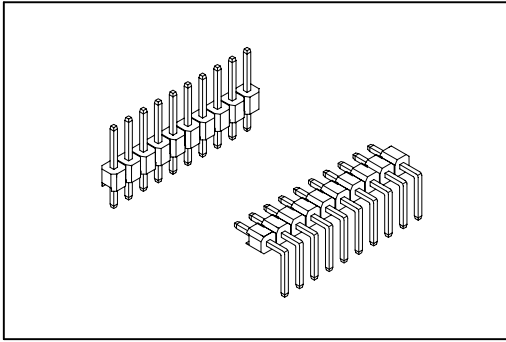

### Material:

Housing: 30% Glass Filled PBT UL94V-0.

Contacts: Brass.

### Electrical Characteristics:

Current Rating: 2 A.

Dielectric Withstanding Voltage: AC 1000V.

Insulator Resistance: 1000MΩ min.

Contact Resistance: 20mΩ max.

Operating Temperature: -40°C ~ +105°C.

### Features:

- \* Available in Straight, Right angle and Press Fit
- \* Side-to-side and end-to-end stackable.
- \* Custom design offered.

Mates with: 2006, 2041, 2042, 2043, 2044, 2045  
2047, 2048, 2049, 4071

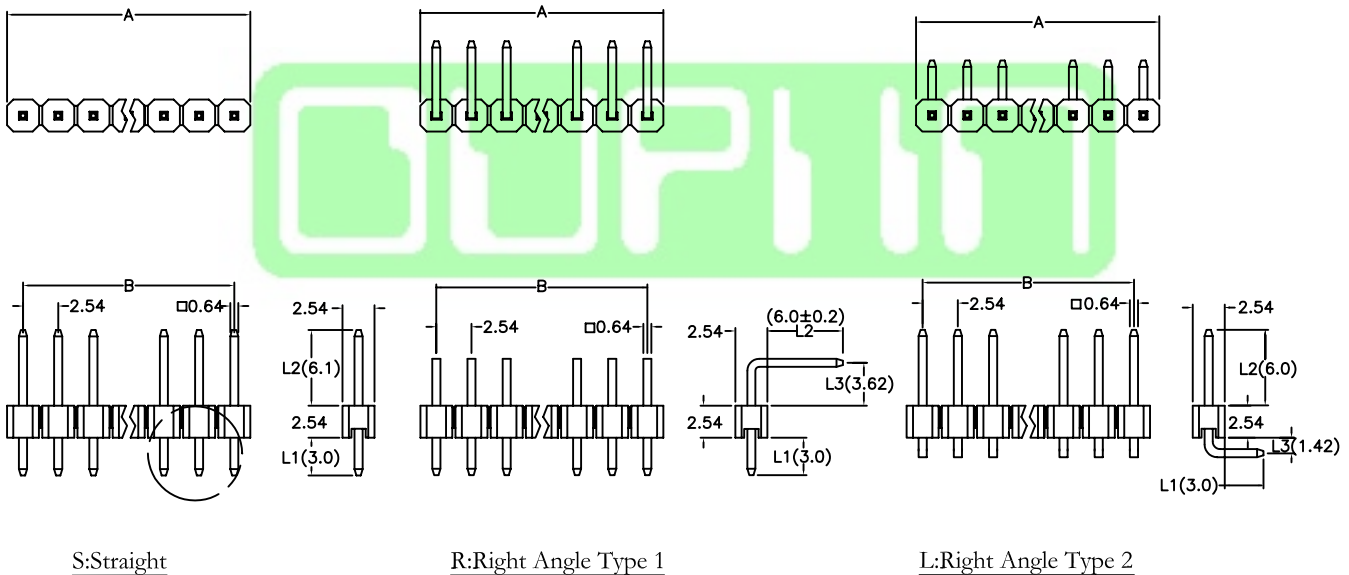

Dip Type

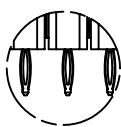

Press Fit Type

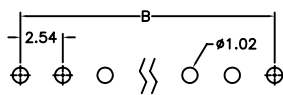

P.C. Board Layout

Position Dimension	2 Thru 40
A	2.54 X No. of Positions
B	2.54 X No. of Positions - 2.54

## Ordering information

**2011-** Series    **1** Single Row    **X** No. of Pin Per Row    **40**    **G** G: Gold Plated    T: Tin Plated    **00** 00: G/F    **S** S: Straight    R: Right Angle Type 1    L: Right Angle Type 2    **P** Blank: Dip Type    P: Press Fit Type    **B** B: Bulk Package

Custom Design: Straight (i.e. 2011-1 X 40 G 00 S/L1 /L2)  
 Right Angle (i.e. 2011-1X40G00R/L1 /L2 /L3 & 2011-1X40G00L/L1/L2/L3)  
 L1: Dip Length  
 L2: Mating length  
 L3: Extended Length (6 Choices: 1.42mm, 1.97mm, 2.07mm, 2.32mm, 2.92mm, 3.62mm.)